

N20-1208-16

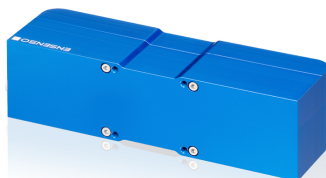

## Spécification

### Caractéristiques techniques

Distance de travail minimale	330 mm
Distance de travail maximale	360 mm
Distance de travail optimale	340 mm
Distance focale	12 mm
Poids	550 g
Angle de vergence	8,00
Résolution (h x v)	1280 x 1024
Dimensions H/W/L	50,0 mm x 175,0 mm x 50,0 mm
Nombre de diaphragme	1,6
Format de base	100 mm
Consommation d'électricité	9,5 W

## N20-1208-16

### Volume de mesure

Distance	Résolution Z	Taille du champ d'image en X	Taille du champ d'image en Y	Flou optique	Grosseur de pixel
321 mm	0.055 mm	156.36 mm	139.00 mm	2.453 px	0.136 mm
322 mm	0.055 mm	157.16 mm	139.43 mm	2.370 px	0.136 mm
324 mm	0.056 mm	158.76 mm	140.30 mm	2.204 px	0.137 mm
326 mm	0.056 mm	160.35 mm	141.17 mm	2.041 px	0.138 mm
328 mm	0.057 mm	161.95 mm	142.03 mm	1.880 px	0.139 mm
330 mm	0.058 mm	163.55 mm	142.90 mm	1.720 px	0.140 mm
332 mm	0.058 mm	165.15 mm	143.76 mm	1.563 px	0.140 mm
334 mm	0.059 mm	166.74 mm	144.63 mm	1.407 px	0.141 mm
336 mm	0.060 mm	168.34 mm	145.50 mm	1.253 px	0.142 mm
338 mm	0.060 mm	169.94 mm	146.36 mm	1.100 px	0.143 mm
340 mm	0.061 mm	171.53 mm	147.23 mm	0.950 px	0.144 mm
342 mm	0.062 mm	173.13 mm	148.09 mm	1.072 px	0.145 mm
344 mm	0.063 mm	174.73 mm	148.96 mm	1.214 px	0.145 mm
346 mm	0.063 mm	176.33 mm	149.83 mm	1.355 px	0.146 mm
348 mm	0.064 mm	177.92 mm	150.69 mm	1.495 px	0.147 mm
350 mm	0.065 mm	179.52 mm	151.56 mm	1.633 px	0.148 mm
352 mm	0.066 mm	181.12 mm	152.42 mm	1.769 px	0.149 mm
354 mm	0.066 mm	182.71 mm	153.29 mm	1.899 px	0.150 mm
356 mm	0.067 mm	184.30 mm	154.16 mm	2.028 px	0.151 mm
358 mm	0.068 mm	185.89 mm	155.02 mm	2.155 px	0.151 mm
360 mm	0.069 mm	187.48 mm	155.89 mm	2.280 px	0.152 mm

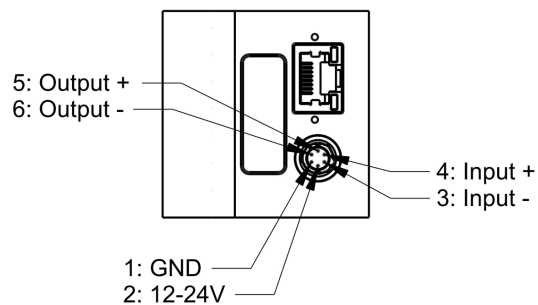
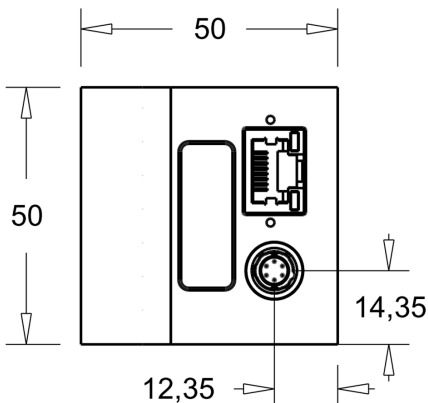
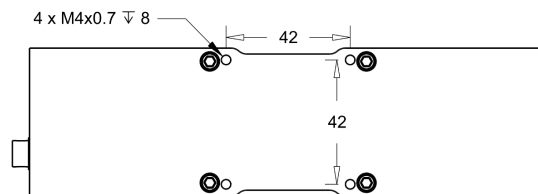
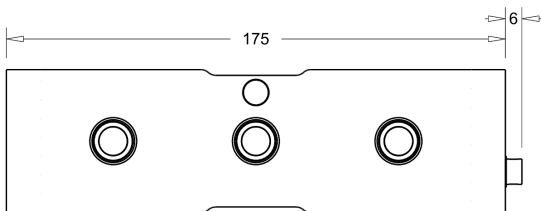

Sous réserve de modifications techniques

N20-1208-16

